

# Waukesha County GIS Viewer and Tax Listing

## Frequently Asked Questions

[How can I find out if my property has a plat of survey?](#)

[How do I acquire a new Plat of Survey for my property?](#)

[Is there a way to see a representation of my property boundaries?](#)

[How do I find information on a property's well and septic system?](#)

[What is GIS and what can it be used for?](#)

[How do I get an address or owner name corrected on a tax bill?](#)

[Who do I contact for a question on how a boundary is portrayed on the GIS?](#)

[Who do I contact for an issue with the GIS Viewer?](#)

# How can I find out if my property has a Plat of Survey?

Plats of survey are property surveys conducted by private licensed surveyors for landowners. These documents are used for buying and selling property as well as other uses. Once completed, surveyors are encouraged to file them at the Register of Deeds office, but it is not required. To find out if your property has had one filed, you can either:

1. Search online using the [Register of Deeds Document Search](#) and searching by the Public Survey System Quarter Section that your property falls within.

The screenshot shows the 'Waukesha County Register of Deeds Public Access' website. The page has a navigation menu with 'Welcome', 'Real Estate', and 'FAQ'. Below the menu is a 'Real Estate Document Access' section with a search form. The search form includes fields for 'Date Filed From', 'To', 'Instrument # From', 'To', 'Book', and 'Page'. A 'Document Type' dropdown menu is open, showing options like 'PLAT OF SURVEY', 'PLU STORM WATER NON RECORDED', 'POWER OF ATTORNEY', 'POWTS AGREEMENT', and 'PROBATE - FORMAL'. Below the search form are sections for 'Cross References', 'Common' (with 'Tax Id' and 'Municipality' fields), 'Platted Description' (with 'Subdivision', 'Lot', 'Block', and 'Out Lot' fields), 'Condo Description' (with 'Condo', 'Boat Slip', 'Building', 'Locker', 'Parking Space', 'Unit', 'Storage', and 'Garage' fields), and 'Unplatted Description' (with 'Township', 'Section', 'Range', and 'Qtr' dropdowns).

2. Call the Register of Deeds Real Estate division at: 262-548-7589

## How do I acquire a new Plat of Survey for my property?

Private property surveys can be contracted with registered land surveyors throughout southeastern Wisconsin. A Google search for land surveyors would provide a good list of surveyors in the area. It is worth noting that a Plat of Survey has no legal standing and is different than a [Certified Survey Map](#). [Certified Survey Maps](#) are reviewed for compliance and approval prior to being recorded at the Register of Deeds Office.

[Home](#)

## Is there a way to see a representation of my property boundaries?

The [Waukesha County GIS Viewer](#) is an application that enables property owners to search and query their parcel, overlay layers of data to find out things like school and County board supervisory districts as well as a host of environmental layers and aerial photography.

[Home](#)

## How do I find information on a property's well and septic system?

Please contact the Waukesha County [Environmental Health Division](#) at: 262-896-8300. Also note the [GIS Viewer](#) does have a Private Onsite Wastewater Treatment System layer which shows those properties with septic systems. How to turn that layer on is shown below.

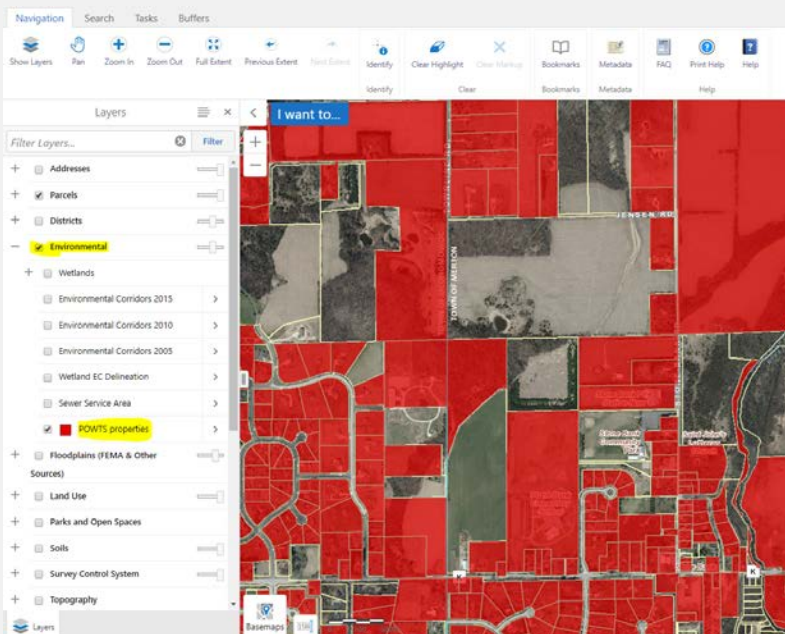

## What is the GIS Viewer and what can it be used for?

The Waukesha County [GIS Viewer](#) is a way to visualize geographic information for any properties within the County. The property parcels include links to the [County Tax File](#). Many of the other geographic layers are linked to other systems and data, as well. While use of the GIS Viewer is not intended to replace a site survey, it does provide a starting point with which homeowners and businesses can search properties and get simple site assessments without having to come into County offices.

## How do I get an address or owner name corrected on a tax bill?

For tax bill address corrections please contact the Waukesha County [Tax Listing Department](#) at 262-548-7597. If the address point is incorrect on the parcel in the GIS Viewer (See below), please contact the [LIS Department](#)

GIS Viewer Address Example

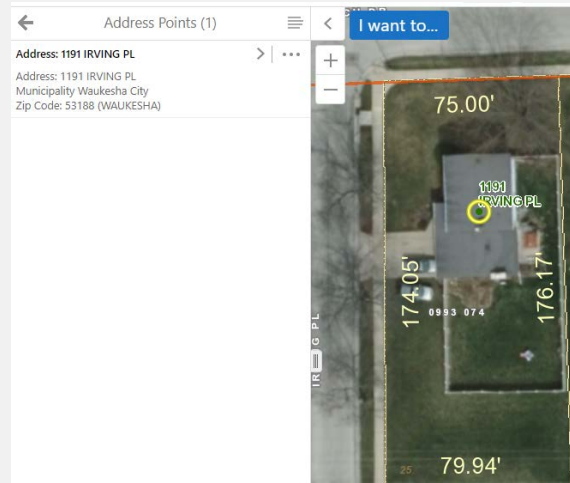

## Who do I contact for a question on how a boundary is portrayed on the GIS?

Inquiries about parcel boundaries should be submitted by email with supporting documentation attachments including, legal descriptions, deeds, plats or other documents to the Waukesha County [Tax Listing Division](#)

[Home](#)

## Who do I contact for an issue with the GIS Viewer?

There is a [Help File](#) for the GIS Viewer [Here](#).

If you need help with how to print, [Click Here](#).

There is a Frequently Asked Question Page, [Here](#).

Still have a question? Please [email](#) the Land Information Systems division.

[Home](#)