

ENROLLED ORDINANCE 179-39

MODIFY SPEED ZONE ON CTH ZZ FROM 3,570 FEET EAST OF THE CENTERLINE OF  
CTH E TO INTERSECTION WITH WISCONSIN STATE HIGHWAY 59

WHEREAS, Wisconsin Statutes §349.11 permits local authorities to modify speed restrictions within statutory guidelines; and

WHEREAS, in response to public inquiries, the Waukesha County Department of Public Works finds it appropriate, pursuant to Wisconsin Statutes §346.57(4)(h) and §349.11(1)(a) and (3)(c), to modify the speed limit to 45 mph in both directions of County Trunk Highway ZZ from a point at 3,570 feet east of the centerline of County Trunk Highway E easterly to the point of intersection with Wisconsin State Highway 59.

THE COUNTY BOARD OF SUPERVISORS OF THE COUNTY OF WAUKESHA ORDAINS that the speed zone along both directions of County Trunk Highway ZZ in the Village of North Prairie and Town of Genesee is modified to forty-five (45) miles per hour from a point at 3,570 feet east of the centerline of County Trunk Highway E easterly to the point of intersection with Wisconsin State Highway 59.

BE IT FURTHER ORDAINED that this ordinance rescinds all previous speed restrictions for the above-described portion of the County Trunk Highway System.

MODIFY SPEED ZONE ON CTH ZZ FROM 3,570 FEET EAST OF THE CENTERLINE OF CTH E TO INTERSECTION WITH WISCONSIN STATE HIGHWAY 59

Presented by:  
Public Works Committee

  
Keith Hammitt, Chair

  
James Batzko

  
Robert L. Kolb

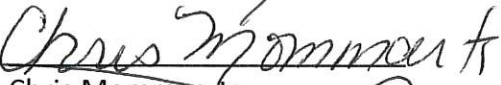
  
Chris Mommaerts

  
Thomas J. Schellinger

  
Steve Styza

  
Terry Thome

The foregoing legislation adopted by the County Board of Supervisors of Waukesha County, Wisconsin, was presented to the County Executive on:

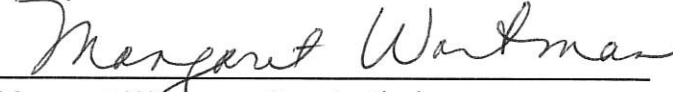
Date: 9/30/24,   
Margaret Wartman, County Clerk

The foregoing legislation adopted by the County Board of Supervisors of Waukesha County, Wisconsin, is hereby:

Approved: X

Vetoed: \_\_\_\_\_

Date: 9/30/2024,   
Paul Farrow, County Executive

Paul Farrow  
County Executive

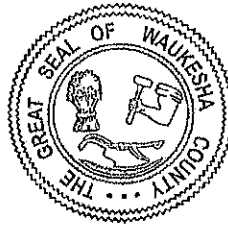

Allison Bussler  
Director

WAUKESHA COUNTY  
DEPARTMENT OF PUBLIC WORKS

**TO:** Waukesha County Board of Supervisors

**CC:** Allison Bussler

**FROM:** Brett Wallace, P.E.

**DATE:** August 21, 2024

**SUBJECT:** Proposed reduction of posted speed limit on CTH ZZ from STH 59 to 3,570 feet east of the centerline of CTH E in the Village of North Prairie and the Town of Genesee.

This proposed modifying of the speed zone on CTH ZZ from STH 59 to 3,570 feet east of the centerline of CTH E, with the modified limit being 45 mph, was determined based on engineering field data collection and coordination with proposed development.

This section of CTH ZZ, from STH 59 to 3,570 feet east of the centerline of CTH E, is within the border of the Village of North Prairie and the Town of Genesee. Pursuant to §346.57(4)(h) and §349.11(3)(c), Wis. Stats., the county has authority to modify the limits on CTH ZZ.

An engineering speed study was performed on CTH ZZ from CTH E and STH 59 in early of May 2024. From May 7<sup>th</sup> through May 9<sup>th</sup>, the speeds of sufficient vehicles to meet current standards were recorded using a radar speed sensor. The 85<sup>th</sup> percentile speed on this section of road was 55 mph as vehicles passed CTH E during the period of the study. However, the 85<sup>th</sup> percentile speed drops to 45 mph approximately 0.6 miles east of CTH E and remains 45 mph as vehicles approach STH 59. Lowering the speed limit on this section of CTH ZZ will bring it into alignment with accepted speed zone setting practices.

The incidence of traffic accidents is below the state average for this section's class of road. In the period from January 2019 through December 2023, there were two crashes along this section of CTH ZZ. The traffic incidents were a rear end crash at the stop sign controlled t-intersection, and one driver cited for driving while under the influence after running into mailboxes.



LAND INFORMATION SYSTEMS DIVISION

# County Trunk Highway ZZ - Proposed Speed Limit Reduction - 55 mph to 45 mph



0 2,500.00 Feet

The information and depictions herein are for informational purposes and Waukesha County specifically disclaims accuracy in this reproduction and specifically admonishes and advises that, if specific and precise accuracy is required, the same should be determined by procurement of certified maps, surveys, plats, Flood Insurance Studies, or other official means. Waukesha County will not be responsible for any damages which result from third party use of the information and depictions herein, or for use which ignores this warning.

**Notes:**

Printed: 7/23/2024



# GENESEE TOWNSHIP WAUKESHA COUNTY, WISCONSIN

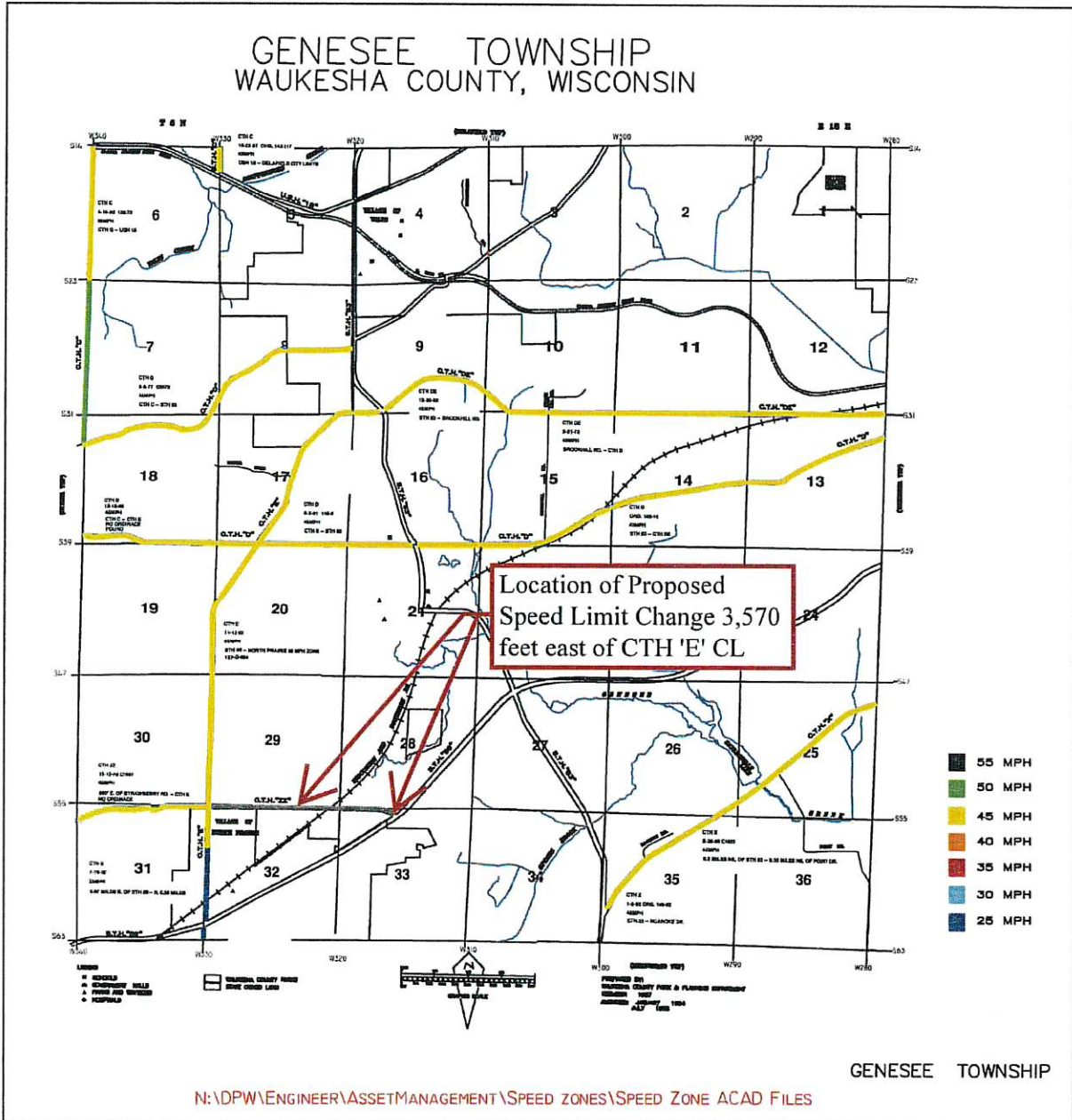

VOTE RESULTS >

22 YES 0 NO 0 ABSTAIN 3 ABSENT

**Ordinance 179-O-040**

Ordinance 179-O-040: Modify Speed Zone on CTH ZZ from 3,570 Feet East of the Centerline of CTH E to Inte

 **Passed By Majority Vote**

D1 - Styza	AVE	D10 - Thieme	S	AVE	D19 - Enriquez	AVE
D2 - Euclide	AVE	D11 - Howard		AVE	D20 - Schellinger	AVE
D3 - Morris	AVE	D12 - Wolff		AVE	D21 - Gaughan	AVE
D4 - Batzko	M	D13 - Leisemann		AVE	D22 - Szpara	AVE
D5 - Grant	AVE	D14 - Mommaerts		AVE	D23 - Hammitt	ABSENT
D6 - Walz	AVE	D15 - Kolb		AVE	D24 - Bangs	AVE
D7 - LaFontain	ABSENT	D16 - Crowley		AVE	D25 - Johnson	AVE
D8 - Koremenos	AVE	D17 - Meier		ABSENT		
D9 - Heinrich	AVE	D18 - Nelson		AVE		