

ENROLLED ORDINANCE 169-81

LAYING OUT, RELOCATION AND IMPROVEMENT OF COUNTY TRUNK HIGHWAY P,
WAUKESHA COUNTY PROJECT, PROJECT I.D. 2714-04-00, BARK RIVER BRIDGE
AND APPROACHES, VILLAGE OF SUMMIT, WAUKESHA COUNTY

WHEREAS, the County Board of Supervisors of Waukesha County finds that the proper improvement in maintenance of County Trunk Highway P in the Village of Summit, from a point that is 447.16 feet North of the West corner of Section 24, Town 7 North, Range 17 East, Village of Summit, Waukesha County, State of Wisconsin to a point that is 901.89 feet North of the West corner of Section 24, Town 7 North, Range 17 East, Village of Summit, Waukesha County, State of Wisconsin requires certain relocation or changes and the acquisition of certain rights of way as shown on the plat marked "Plat of Right of Way Required for CTH P, Project I.D. 2714-04-00, Bark River Bridge and Approaches, Waukesha County".

THE COUNTY BOARD OF SUPERVISORS OF THE COUNTY OF WAUKESHA DOES ORDAIN that County Trunk Highway P in the Village of Summit is hereby changed or relocated from a point that is 447.16 feet North of the West corner of Section 24, Town 7 North, Range 17 East, Village of Summit, Waukesha County, State of Wisconsin to a point that is 901.89 feet North of the West corner of Section 24, Town 7 North, Range 17 East, Village of Summit, Waukesha County, State of Wisconsin, certain relocation or changes and the acquisition of certain rights of way as shown on the plat marked "Plat of Right of Way Required for CTH P, Project I.D. 2714-04-00, Bark River Bridge and Approaches, Waukesha County", said plat on file in the County Clerk's office and adopted by reference under the authority granted by Section 83.08 and Chapter 32 of the Wisconsin Statutes.

LAYING OUT, RELOCATION AND IMPROVEMENT OF COUNTY TRUNK HIGHWAY P,
WAUKESHA COUNTY PROJECT, PROJECT I.D. 2714-04-00, BARK RIVER BRIDGE AND
APPROACHES, VILLAGE OF SUMMIT, WAUKESHA COUNTY

Presented by:
Public Works Committee

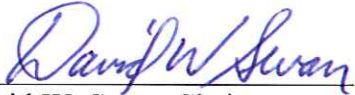

David W. Swan, Chair

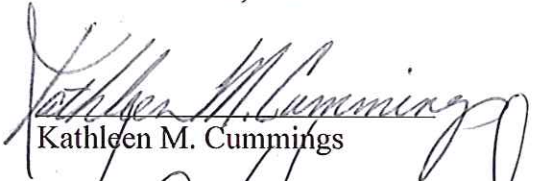

Kathleen M. Cummings

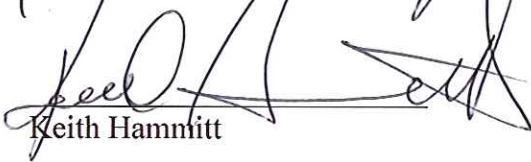

Keith Hammitt

Absent

Robert L. Kolb

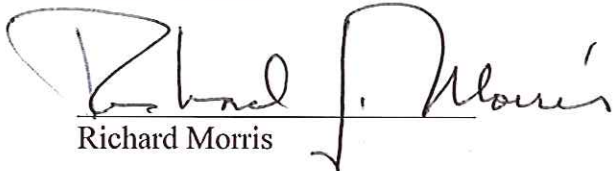

Richard Morris



Carl Pettis

Absent

Steve Whittow

The foregoing legislation adopted by the County Board of Supervisors of Waukesha County,
Wisconsin, was presented to the County Executive on:

Date: 12/16/14, 
Kathleen Novack, County Clerk

The foregoing legislation adopted by the County Board of Supervisors of Waukesha County,
Wisconsin, is hereby:

Approved: X

Vetoed: _____

Date: 12-22-14, 
Daniel P. Vrakas, County Executive

R/W PROJECT NUMBER
2714-04-00

FEDERAL PROJECT NUMBER
41

SHEET TOTAL NUMBER SHEETS
2

PLAT OF RIGHT-OF-WAY REQUIRED FOR
BARK RIVER BRIDGE & APPROACHES
VILLAGE OF SUMMIT
C.T.H. P (SAWYER ROAD) WAUKESHA COUNTY
CONSTRUCTION PROJECT NUMBER
2714-04-70

LEFT
MILE
PAGE
POINT OF CURVATURE
PRIVATE ENTRANCE
PERM.
BARN
POINT OF INTERSECTION
POINT OF TANGENCY
PERMANENT LIMITED EASEMENT
RADIUS
RESTRICTED DEVELOPMENT EASEMENT
REMAINING
RESTAURANT
RIGHT OF WAY
R/W
SCHED
STORM DRAINAGE
SQUARE FEET
STATION
TANK
TAVEN
TEMPORARY LIMITED EASEMENT
TEMPORARY LIMITED EASEMENT
VOLUME
WALL

AC
ALUM. MON.
A.P.
B
B.M.
C
C.E.
C/O
CONC. MON.
CONST.
C.P.
C.S.M.
D
ETAL
F.E.
F.R.L.
F.T.
G
H
L
L.C.
L.C.B.

AREAD
ALUM. MON.
ACCESS POINT
BARN
BENCH MARK
CHURCH
COMMERCIAL ENTRANCE
CONCRETE MONUMENT
CONSTRUCTION
C.O.
C.S.M.
D
ETAL
FIELD ENTRANCE
FRACTIONAL
FEET
GARAGE
HOUSE
LENGTH OF CURVE
LONG CHORD OF CURVE
LONG CHORD BEARING

AG
ALUM. MON.
A.P.
B
B.M.
C
C.E.
C/O
CONC. MON.
CONST.
C.P.
C.S.M.
D
ETAL
F.E.
F.R.L.
F.T.
G
H
L
L.C.
L.C.B.

AC
ALUM. MON.
A.P.
B
B.M.
C
C.E.
C/O
CONC. MON.
CONST.
C.P.
C.S.M.
D
ETAL
F.E.
F.R.L.
F.T.
G
H
L
L.C.
L.C.B.

AC
ALUM. MON.
A.P.
B
B.M.
C
C.E.
C/O
CONC. MON.
CONST.
C.P.
C.S.M.
D
ETAL
F.E.
F.R.L.
F.T.
G
H
L
L.C.
L.C.B.

AC
ALUM. MON.
A.P.
B
B.M.
C
C.E.
C/O
CONC. MON.
CONST.
C.P.
C.S.M.
D
ETAL
F.E.
F.R.L.
F.T.
G
H
L
L.C.
L.C.B.

CONVENTIONAL SIGNS AND ABBREVIATIONS

NON-COMPENSABLE

COMPENSABLE

SERVICE FEDESTAL

POWER POLE

TELEPHONE POLE

SIGN

NO ACCESS (BY ACQUISITION)

NO ACCESS (BY STATUTORY AUTHORITY)

NO ACCESS (BY PREVIOUS PROJECT)

PERMANENT LIMITED EASEMENT

TEMPORARY LIMITED EASEMENT

FEE

NON-MONUMENTED SURVEY POINT

SECTION CORNER

BUSHES

TREES (DECIDUOUS)

TREES (CONIFEROUS)

WOODS

HAZARDOUS UTILITY SITE

CULVERT (BOX, PIPE OR ON TILE PAVES)

RAIL LINE

FOUNDATION OR RUIN

BUILDING

CEMETERY

TELEPHONE FEDESTAL

IRON PIN

VALVE

SEA MANHOLE, MOUNT ETC.

WELL

CONVENTIONAL SIGNS AND ABBREVIATIONS

NON-COMPENSABLE

COMPENSABLE

SERVICE FEDESTAL

POWER POLE

TELEPHONE POLE

SIGN

NO ACCESS (BY ACQUISITION)

NO ACCESS (BY STATUTORY AUTHORITY)

NO ACCESS (BY PREVIOUS PROJECT)

PERMANENT LIMITED EASEMENT

TEMPORARY LIMITED EASEMENT

FEE

NON-MONUMENTED SURVEY POINT

SECTION CORNER

BUSHES

TREES (DECIDUOUS)

TREES (CONIFEROUS)

WOODS

HAZARDOUS UTILITY SITE

CULVERT (BOX, PIPE OR ON TILE PAVES)

RAIL LINE

FOUNDATION OR RUIN

BUILDING

CEMETERY

TELEPHONE FEDESTAL

IRON PIN

VALVE

SEA MANHOLE, MOUNT ETC.

WELL

CONVENTIONAL SIGNS AND ABBREVIATIONS

NON-COMPENSABLE

COMPENSABLE

SERVICE FEDESTAL

POWER POLE

TELEPHONE POLE

SIGN

NO ACCESS (BY ACQUISITION)

NO ACCESS (BY STATUTORY AUTHORITY)

NO ACCESS (BY PREVIOUS PROJECT)

PERMANENT LIMITED EASEMENT

TEMPORARY LIMITED EASEMENT

FEE

NON-MONUMENTED SURVEY POINT

SECTION CORNER

BUSHES

TREES (DECIDUOUS)

TREES (CONIFEROUS)

WOODS

HAZARDOUS UTILITY SITE

CULVERT (BOX, PIPE OR ON TILE PAVES)

RAIL LINE

FOUNDATION OR RUIN

BUILDING

CEMETERY

TELEPHONE FEDESTAL

IRON PIN

VALVE

SEA MANHOLE, MOUNT ETC.

WELL

CONVENTIONAL SIGNS AND ABBREVIATIONS

NON-COMPENSABLE

COMPENSABLE

SERVICE FEDESTAL

POWER POLE

TELEPHONE POLE

SIGN

NO ACCESS (BY ACQUISITION)

NO ACCESS (BY STATUTORY AUTHORITY)

NO ACCESS (BY PREVIOUS PROJECT)

PERMANENT LIMITED EASEMENT

TEMPORARY LIMITED EASEMENT

FEE

NON-MONUMENTED SURVEY POINT

SECTION CORNER

BUSHES

TREES (DECIDUOUS)

TREES (CONIFEROUS)

WOODS

HAZARDOUS UTILITY SITE

CULVERT (BOX, PIPE OR ON TILE PAVES)

RAIL LINE

FOUNDATION OR RUIN

BUILDING

CEMETERY

TELEPHONE FEDESTAL

IRON PIN

VALVE

SEA MANHOLE, MOUNT ETC.

WELL

CONVENTIONAL SIGNS AND ABBREVIATIONS

NON-COMPENSABLE

COMPENSABLE

SERVICE FEDESTAL

POWER POLE

TELEPHONE POLE

SIGN

NO ACCESS (BY ACQUISITION)

NO ACCESS (BY STATUTORY AUTHORITY)

NO ACCESS (BY PREVIOUS PROJECT)

PERMANENT LIMITED EASEMENT

TEMPORARY LIMITED EASEMENT

FEE

NON-MONUMENTED SURVEY POINT

SECTION CORNER

BUSHES

TREES (DECIDUOUS)

TREES (CONIFEROUS)

WOODS

HAZARDOUS UTILITY SITE

CULVERT (BOX, PIPE OR ON TILE PAVES)

RAIL LINE

FOUNDATION OR RUIN

BUILDING

CEMETERY

TELEPHONE FEDESTAL

IRON PIN

VALVE

SEA MANHOLE, MOUNT ETC.

WELL

CONVENTIONAL SIGNS AND ABBREVIATIONS

NON-COMPENSABLE

COMPENSABLE

SERVICE FEDESTAL

POWER POLE

TELEPHONE POLE

SIGN

NO ACCESS (BY ACQUISITION)

NO ACCESS (BY STATUTORY AUTHORITY)

NO ACCESS (BY PREVIOUS PROJECT)

PERMANENT LIMITED EASEMENT

TEMPORARY LIMITED EASEMENT

FEE

NON-MONUMENTED SURVEY POINT

SECTION CORNER

BUSHES

TREES (DECIDUOUS)

TREES (CONIFEROUS)

WOODS

HAZARDOUS UTILITY SITE

CULVERT (BOX, PIPE OR ON TILE PAVES)

RAIL LINE

FOUNDATION OR RUIN

BUILDING

CEMETERY

TELEPHONE FEDESTAL

IRON PIN

VALVE

SEA MANHOLE, MOUNT ETC.

WELL

END RELOCATION ORDER
PROJECT ID: 2714-04-00 STA. 105+36.42
891.88 FEET NORTH OF THE WEST
CORNER OF SECTION 24, T.7N., R.17E.
N= 389107.02
E= 2418548.31

BEGIN RELOCATION ORDER
PROJECT ID: 2714-04-00 STA. 100+80.35
447.16 FEET NORTH OF THE WEST
CORNER OF SECTION 24, T.7N., R.17E.
N= 388650.85
E= 2410554.37

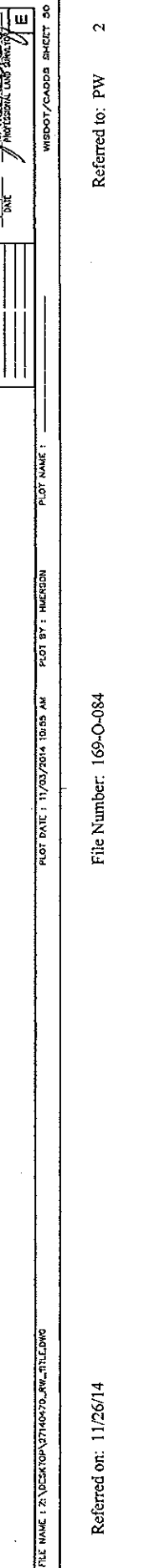
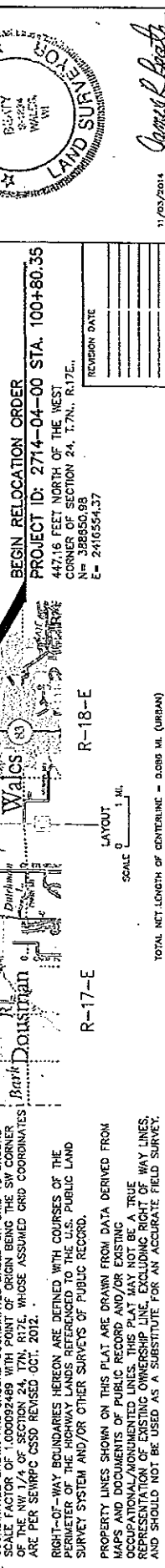
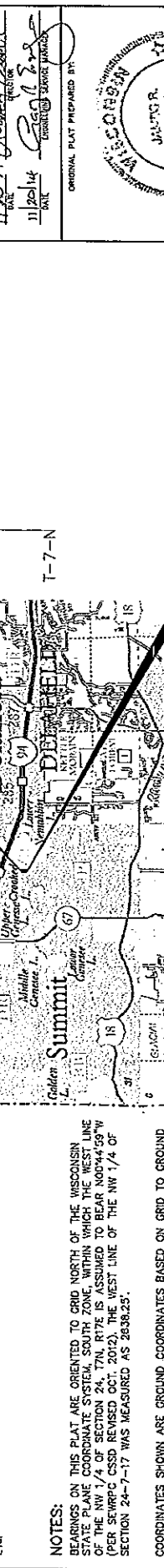
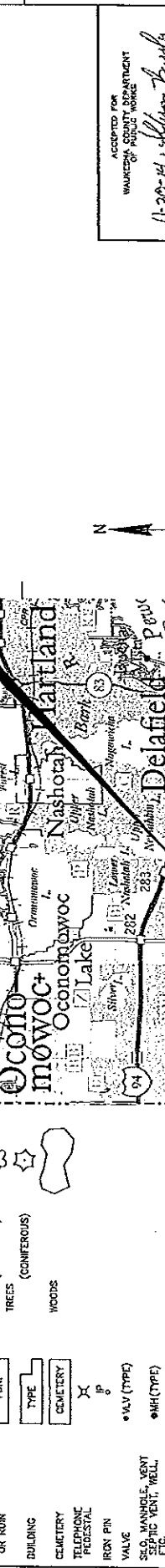
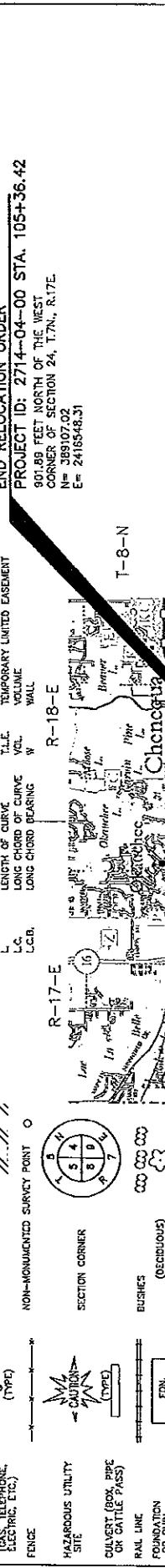
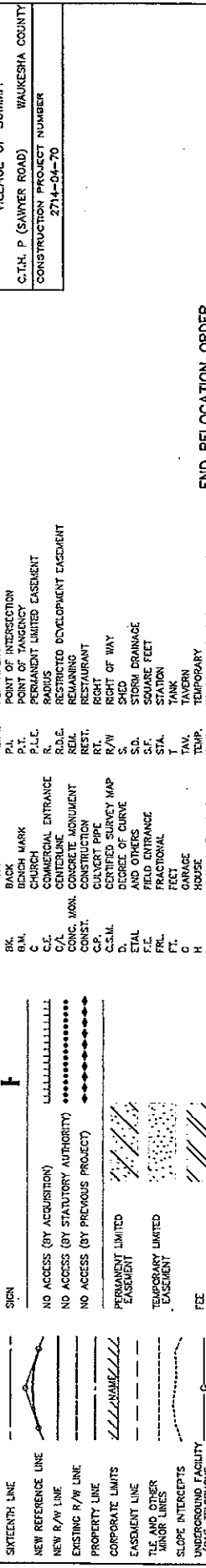

NOTES:

BEARINGS ON THIS PLAT ARE ORIENTED TO GRID NORTH OF THE WISCONSIN PLANE COORDINATE SYSTEM, SOUTH ZONE, WITHIN WHICH THE WEST LINE OF THE NW 1/4 OF SECTION 24, T.7N., R.17E. WHOSE ASSUMED GRID COORDINATES ARE PER SEWRPC/CSSD REVISED OCT. 2012.

RIGHT-OF-WAY BOUNDARIES HEREON ARE DEFINED WITH COURSES OF THE PERIMETER OF THE HIGHWAY LANDS REFERENCED TO THE U.S. PUBLIC LAND SURVEY SYSTEM AND/OR OTHER SURVEYS OF PUBLIC RECORD.

PROPERTY LINES SHOWN ON THIS PLAT ARE DRAWN FROM DATA DERIVED FROM MAPS AND DOCUMENTS OF PUBLIC RECORD AND/OR EXISTING OCCUPATIONAL/MONUMENTED LINES. THIS PLAT MAY NOT BE A TRUE REPRESENTATION OF EXISTING OWNERSHIP LINE, EXCLUDING RIGHT OF WAY LINES, AND SHOULD NOT BE USED AS A SUBSTITUTE FOR AN ACCURATE FIELD SURVEY.

COORDINATES SHOWN ARE GROUND COORDINATES BASED ON GRID TO GROUND SCALE FACTOR OF 1.000092488 WITH POINT OF ORIGIN BEING THE SW CORNER OF THE NW 1/4 OF SECTION 24, T.7N., R.17E. WHOSE ASSUMED GRID COORDINATES ARE PER SEWRPC/CSSD REVISED OCT. 2012.

RIGHT-OF-WAY BOUNDARIES HEREON ARE DEFINED WITH COURSES OF THE PERIMETER OF THE HIGHWAY LANDS REFERENCED TO THE U.S. PUBLIC LAND SURVEY SYSTEM AND/OR OTHER SURVEYS OF PUBLIC RECORD.

PROPERTY LINES SHOWN ON THIS PLAT ARE DRAWN FROM DATA DERIVED FROM MAPS AND DOCUMENTS OF PUBLIC RECORD AND/OR EXISTING OCCUPATIONAL/MONUMENTED LINES. THIS PLAT MAY NOT BE A TRUE REPRESENTATION OF EXISTING OWNERSHIP LINE, EXCLUDING RIGHT OF WAY LINES, AND SHOULD NOT BE USED AS A SUBSTITUTE FOR AN ACCURATE FIELD SURVEY.

COORDINATES SHOWN ARE GROUND COORDINATES BASED ON GRID TO GROUND SCALE FACTOR OF 1.000092488 WITH POINT OF ORIGIN BEING THE SW CORNER OF THE NW 1/4 OF SECTION 24, T.7N., R.17E. WHOSE ASSUMED GRID COORDINATES ARE PER SEWRPC/CSSD REVISED OCT. 2012.

RIGHT-OF-WAY BOUNDARIES HEREON ARE DEFINED WITH COURSES OF THE PERIMETER OF THE HIGHWAY LANDS REFERENCED TO THE U.S. PUBLIC LAND SURVEY SYSTEM AND/OR OTHER SURVEYS OF PUBLIC RECORD.

PROPERTY LINES SHOWN ON THIS PLAT ARE DRAWN FROM DATA DERIVED FROM MAPS AND DOCUMENTS OF PUBLIC RECORD AND/OR EXISTING OCCUPATIONAL/MONUMENTED LINES. THIS PLAT MAY NOT BE A TRUE REPRESENTATION OF EXISTING OWNERSHIP LINE, EXCLUDING RIGHT OF WAY LINES, AND SHOULD NOT BE USED AS A SUBSTITUTE FOR AN ACCURATE FIELD SURVEY.

AREAS SHOWN IN THE TOTAL AREA TABLE COLUMN MAY BE APPROXIMATE AND ARE DERIVED FROM TAX ROLLS OR OTHER AVAILABLE SOURCES AND MAY NOT INCLUDE LANDS OF THE OWNER WHICH ARE NOT CONTIGUOUS TO THE AREA TO BE ACQUIRED.

SCHEDULE OF LANDS & INTERESTS REQUIRED

PARCEL NUMBER	OWNER	INTERESTS REQUIRED	TOTAL ACRES	NEW ACRES ACQUIRED	TITLE TO BE OBTAINED	TOTAL ACRES	NET ACRES
1	FRANKLIN J. & MARY ANN BRAZELTON	FEE & T.L.E.	8.273	0.18	0.43	0.18	7.773
2	STATE OF WISCONSIN	FEE & T.L.E.	17	0.03	0.24	0.07	16.73
3	JOHN & KAREN JOHNSON	FEE & T.L.E.	1.63	0.003	0.01	0.01	1.62
4	CLUB HUNTOR	FEE & T.L.E.	0.46	0.02	0.00	0.04	0.44
(10)	VE ENERGIES	RELEASE OF RIGHTS					
(102)	VILLAGE OF SUMMIT	RELEASE OF RIGHTS					
(104)	STATE OF WISCONSIN - DOT	RELEASE OF RIGHTS					

OWNERS NAMES ARE SHOWN FOR REFERENCE PURPOSES ONLY AND ARE SUBJECT TO CHANGE PRIOR TO THE TRANSFER OF LAND INTERESTS.

COURSE TABLE - FILE PARCELS

FROM	TO	BEARING	DIST.
100	101	S 89°15'01" W	33.00'
101	102	N 09°44'59" W	22.00'
102	103	N 09°44'59" W	35.317'
103	104	N 09°44'59" W	22.00'
104	105	S 09°44'59" E	33.47'
105	106	S 09°44'59" E	33.47'
106	107	N 09°44'59" E	7.00'
107	108	S 09°44'59" E	16.00'
108	109	N 09°44'59" W	18.00'
109	110	N 09°44'59" W	18.00'
110	111	S 09°44'59" E	18.00'
111	112	N 09°44'59" E	18.00'
112	113	N 09°44'59" E	18.00'
113	114	S 09°44'59" E	18.00'
114	115	N 09°44'59" E	18.00'
115	116	S 09°44'59" E	18.00'
116	117	N 09°44'59" E	18.00'
117	118	N 09°44'59" E	18.00'
118	119	N 09°44'59" E	18.00'
119	120	N 09°44'59" E	18.00'
120	121	S 09°44'59" E	18.00'
121	122	N 09°44'59" E	18.00'
122	123	N 09°44'59" E	18.00'
123	124	S 09°44'59" E	18.00'
124	125	N 09°44'59" E	18.00'
125	126	N 09°44'59" E	18.00'
126	127	S 09°44'59" E	18.00'
127	128	N 09°44'59" E	18.00'
128	129	N 09°44'59" E	18.00'
129	130	S 09°44'59" E	18.00'
130	131	N 09°44'59" E	18.00'
131	132	N 09°44'59" E	18.00'
132	133	S 09°44'59" E	18.00'
133	134	N 09°44'59" E	18.00'
134	135	N 09°44'59" E	18.00'
135	136	S 09°44'59" E	18.00'
136	137	N 09°44'59" E	18.00'
137	138	N 09°44'59" E	18.00'
138	139	S 09°44'59" E	18.00'
139	140	N 09°44'59" E	18.00'
140	141	N 09°44'59" E	18.00'
141	142	S 09°44'59" E	18.00'
142	143	N 09°44'59" E	18.00'
143	144	N 09°44'59" E	18.00'
144	145	S 09°44'59" E	18.00'
145	146	N 09°44'59" E	18.00'
146	147	N 09°44'59" E	18.00'
147	148	S 09°44'59" E	18.00'
148	149	N 09°44'59" E	18.00'
149	150	N 09°44'59" E	18.00'
150	151	S 09°44'59" E	18.00'
151	152	N 09°44'59" E	18.00'
152	153	N 09°44'59" E	18.00'
153	154	S 09°44'59" E	18.00'
154	155	N 09°44'59" E	18.00'
155	156	N 09°44'59" E	18.00'
156	157	S 09°44'59" E	18.00'
157	158	N 09°44'59" E	18.00'
158	159	N 09°44'59" E	18.00'
159	160	S 09°44'59" E	18.00'
160	161	N 09°44'59" E	18.00'
161	162	N 09°44'59" E	18.00'
162	163	S 09°44'59" E	18.00'
163	164	N 09°44'59" E	18.00'
164	165	N 09°44'59" E	18.00'
165	166	S 09°44'59" E	18.00'
166	167	N 09°44'59" E	18.00'
167	168	N 09°44'59" E	18.00'
168	169	S 09°44'59" E	18.00'
169	170	N 09°44'59" E	18.00'
170	171	N 09°44'59" E	18.00'
171	172	S 09°44'59" E	18.00'
172	173	N 09°44'59" E	18.00'
173	174	N 09°44'59" E	18.00'
174	175	S 09°44'59" E	18.00'
175	176	N 09°44'59" E	18.00'
176	177	N 09°44'59" E	18.00'
177	178	S 09°44'59" E	18.00'
178	179	N 09°44'59" E	18.00'
179	180	N 09°44'59" E	18.00'
180	181	S 09°44'59" E	18.00'
181	182	N 09°44'59" E	18.00'
182	183	N 09°44'59" E	18.00'
183	184	S 09°44'59" E	18.00'
184	185	N 09°44'59" E	18.00'
185	186	N 09°44'59" E	18.00'
186	187	S 09°44'59" E	18.00'
187	188	N 09°44'59" E	18.00'
188	189	N 09°44'59" E	18.00'
189	190	S 09°44'59" E	18.00'
190	191	N 09°44'59" E	18.00'
191	192	N 09°44'59" E	18.00'
192	193	S 09°44'59" E	18.00'
193	194	N 09°44'59" E	18.00'
194	195	N 09°44'59" E	18.00'
195	196	S 09°44'59" E	18.00'
196	197	N 09°44'59" E	18.00'
197	198	N 09°44'59" E	18.00'
198	199	S 09°44'59" E	18.00'
199	200	N 09°44'59" E	18.00'
200	201	N 09°44'59" E	18.00'
201	202	S 09°44'59" E	18.00'
202	203	N 09°44'59" E	18.00'
203	204	N 09°44'59" E	18.00'
204	205	S 09°44'59" E	18.00'
205	206	N 09°44'59" E	18.00'
206	207	N 09°44'59" E	18.00'
207	208	S 09°44'59" E	18.00'
208	209	N 09°44'59" E	18.00'
209	210	N 09°44'59" E	18.00'
210	211	S 09°44'59" E	18.00'
211	212	N 09°44'59" E	18.00'
212	213	N 09°44'59" E	18.00'
213	214	S 09°44'59" E	18.00'
214	215	N 09°44'59" E	18.00'
215	216	N 09°44'59" E	18.00'
216	217	S 09°44'59" E	18.00'
217	218	N 09°44'59" E	18.00'
218	219	N 09°44'59" E	18.00'
219	220	S 09°44'59" E	18.00'
220	221	N 09°44'59" E	18.00'
221	222	N 09°44'59" E	18.00'
222	223	S 09°44'59" E	18.00'
223	224	N 09°44'59" E	18.00'
224	225	N 09°44'59" E	18.00'
225	226	S 09°44'59" E	18.00'
226	227	N 09°44'59" E	18.00'
227	228	N 09°44'59" E	18.00'
228	229	S 09°44'59" E	18.00'
229	230	N 09°44'59" E	18.00'
230	231	N 09°44'59" E	18.00'
231	232	S 09°44'59" E	18.00'
232	233	N 09°44'59" E	18.00'
233	234	N 09°44'59" E	18.00'
234	235	S 09°44'59" E	18.00'
235	236	N 09°44'59" E	18.00'
236	237	N 09°44'59" E	18.00'
237	238	S 09°44'59" E	18.00'
238	239	N 09°44'59" E	18.00'
239	240	N 09°44'59" E	18.00'
240	241	S 09°44'59" E	18.00'
241	242	N 09°44'59" E	18.00'
242	243	N 09°44'59" E	18.00'
243	244	S 09°44'59" E	18.00'
244	245	N 09°44'59" E	18.00'
245	246	N 09°44'59" E	18.00'
246	247	S 09°44'59" E	18.00'
247	248	N 09°44'59" E	18.00'
248	249	N 09°44'59" E	18.00'
249	250	S 09°44'59" E	18.00'
250	251	N 09°44'59" E	18.00'
251	252	N 09°44'59" E	18.00'
252	253	S 09°44'59" E	18.00'
253	254	N 09°44'59" E	18.00'
254	255	N 09°44'59" E	18.00'
255	256	S 09°44'59" E	18.00'
256	257	N 09°44'59" E	18.00'
257	258	N 09°44'59" E	18.00'
258	259	S 09°44'59" E	18.00'
259	260	N 09°44'59" E	18.00'
260	261	N 09°44'59" E	18.00'
261	262	S 09°44'59" E	18.00'
262	263	N 09°44'59" E	18.00'
263	264	N 09°44'59" E	18.00'
264	265	S 09°44'59" E	18.00'
265	266	N 09°44'59" E	18.00'
266	267	N 09°44'59" E	18.00'
267	268	S 09°44'59" E	18.00'
268	269	N 09°44'59" E	18.00'
269	270	N 09°44'59" E	18.00'
270	271	S 09°44'59" E	18.00'
271	272	N 09°44'59" E	18.00'
272	273	N 09°44'59" E	18.00'
273	274	S 09°44'59" E	18.00'
274	275	N 09°44'59" E	18.00'
275	276	N 09°44'59" E	18.00'
276	277	S 09°44'59" E	18.00'
277	278	N 09°44'59" E	18.00'
278	279	N 09°44'59" E	18.00'
279	280	S 09°44'59" E	18.00'
280	281	N 09°44'59" E	18.00'
281	282	N 09°44'59" E	18.00'
282	283	S 09°44'59" E	18.00'
283	284	N 09°44'59" E	18.00'
284	285	N 09°44'59" E	18.00'
285	286	S 09°44'59" E	18.00'
286	287	N 09°44'59" E	18.00'
287	288	N 09°44'59" E	18.00'
288	289	S 09°44'59" E	18.00'
289	290	N 09°44'59" E	18.00'
290	291	N 09°44'59" E	18.00'
291	292	S 09°44'59" E	18.00'
292	293	N 09°44'59" E	18.00'
293	294	N 09°44'59" E	18.00'
294	295	S 09°44'59" E	18.00'
295	296	N 09°44'59" E	18.00'
296	297	N 09°44'59" E	18.00'
297	298	S 09°44'59" E	18.00'
298	299	N 09°44'59" E	18.00'
299	300	N 09°44'59" E	18.00'
300	301	S 09°44'59" E	18.00'
301	302	N 09°44'59" E	18.00'
302	303	N 09°44'59" E	18.00'
303	304	S 09°44'59" E	18.00'
304	305	N 09°44'59" E	18.00'
305	306	N 09°44'59" E	18.00'
306	307	S 09°44'59" E	18.00'
307	308	N 09°44'59" E	18.00'
308	309	N 09°44'59" E	18.00'
309	310	S 09°44'59" E	18.00'
310	311	N 09°44'59" E	18.00'
311	312	N 09°44'59" E	18.00'
312	313	S 09°44'59" E	18.00'
313	314	N 09°44'59" E	18.00'
314	315	N 09°44'59" E	18.00'
315	316	S 09°44'59" E	18.00'
316	317	N 09°44'59" E	18.00'
317	318	N 09°44'59" E	18.00'
318	319	S 09°44'59" E	18.00'
319	320	N 09°44'59" E	18.00'
320	321	N 09°44'59" E	18.00'
321	322	S 09°44'59" E	18.00'
322	323	N 09°44'59" E	18.00'
323	324	N 09°44'59" E	18.00'
324	325	S 09°44'59" E	18.00'
325	326	N 09°44'59" E	18.00'
326	327	N 09°44'59" E	18.00'
327	328	S 09°44'59" E	18.00'
328	329	N 09°44'59" E	18.00'
329	330	N 09°44'59" E	18.00'
330	331	S 09°44'59" E	18.00'
331	332	N 09°44'59" E	18.00'
332	333	N 09°44'59" E	18.00'
333	334	S 09°44'59" E	18.00'
334	335	N 09°44'59" E	18.00'
335	336	N 09°44'59" E	18.00'
336	337	S 09°44'59" E	18.00'
337	338	N 09°44'59" E	18.00'
338	339	N 09°44'59" E	18.00'
339	340	S 09°44'59" E	18.00'
340	341	N 09°44'59" E	18.00'
341	342	N 09°44'59" E	18.00'
342			

WAUKESHA COUNTY BOARD OF SUPERVISORS

V

DATE-12/16/14

(ORD) NUMBER-1690084

1 R. KOLB.....AYE
 3 R. MORRIS.....AYE
 5 J. BRANDTJEN.....AYE
 7 J. GRANT.....AYE
 9 J. HEINRICH.....AYE
 11 C. HOWARD.....AYE
 13 P. DECKER.....AYE
 15 B. MITCHELL.....AYE
 17 D. PAULSON.....AYE
 19 K. CUMMINGS.....AYE
 21 W. ZABOROWSKI.....AYE
 23 K. HAMMITT.....AYE
 25 G. YERKE.....AYE

2 D. Zimmermann.....AYE
 4 J. BATZKO.....AYE
 6 J. WALZ.....AYE
 8 E. HIGHUM.....AYE
 10 D. SWAN.....AYE
 12 P. WOLFF.....AYE
 14 C. PETTIS.....AYE
 16 M. CROWLEY.....AYE
 18 L. NELSON.....AYE
 20 T. SCHELLINGER.....AYE
 22 P. JASKE.....AYE
 24 S. WHITTOW.....*AYE*

TOTAL AYES-⁵24

TOTAL NAYS-00

CARRIED _____

DEFEATED _____

UNANIMOUS X

TOTAL VOTES-24